

2 CAR GARAGE

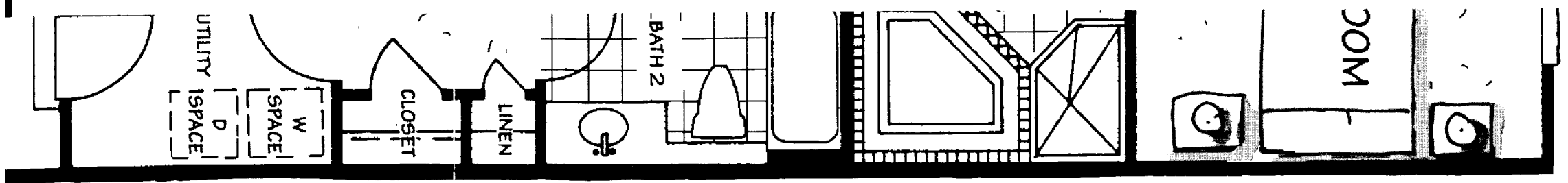

Living Room	13' 0" x 15' 0"
Dining Room	13' 0" x 10' 0"
Eat-in Kitchen	13' 0" x 11' 6"
Library	12' 6" x 10' 6"
Master Bedroom	14' 0" x 13' 6"
Bedroom #2	12' 6" x 12' 0"
Total Square Footage	1640

- Architect-designed attached single-family villas
- Maintenance-free lap siding and decorative trim
- 25-year architectural dimensional roof shingles
- Double-hung low-maintenance windows with a sound transmission class rating of 35
- Insulated metal raised panel garage door
- Professionally-planned landscape program
- Patio or deck (site specific)
- Covered entry
- Attached two-car garage
- Electric garage door opener
- Concrete walkway and steps
- Paved asphalt driveway
- Exterior lighting front and rear
- 2 or 3 bedrooms
- 2 or 2 1/2 baths (plan specific)
- Generous first level master suites with ample walk-in closets
- Elegant volume ceilings (per plan)
- 9' ceilings on first floor
- Hardwood or ceramic tile flooring in foyer and kitchen
- Gas fireplace with slate surround and hearth
- Insulated raised panel front door
- Double glazed sliding patio door
- Designer lighting throughout
- Luxurious wall-to-wall carpeting throughout
- Raised panel interior doors
- Abundant closets
- Security System
- Custom kitchen
- Bright windowed breakfast area
- Choice of 12" x 12" ceramic tile or hardwood flooring
- Custom wood cabinetry in a choice of styles and finishes
- Laminate countertop in choice of colors
- Side-by-side refrigerator with ice and water dispenser
- Gas cooktop
- Electric self-cleaning oven
- Microwave
- Ultra-quiet multi-cycle dishwasher
- Stainless steel double bowl sink with single lever faucet
- Garbage disposal
- Luxurious designer ceramic tile in master bath with dual lavs
- Soaking tub in master bath
- Separate glass-enclosed shower
- Coordinated fixtures and faucets
- Laminate countertops in master and secondary baths
- Ceramic tile flooring and tub surround in secondary bath
- Powder room with pedestal sink and ceramic tile floor (per plan)
- Exhaust fans in all baths
- R-11 Batt Insulation between floors and bathroom partitions
- Quality wood frame construction
- Engineered wood truss floor and roof systems
- 25-year architectural dimensional roof shingles
- Basements
 - Poured concrete basement walls with Owens-Corning Tuf-N-Dry waterproof system
 - R-38 ceiling insulation
 - R-15 wall insulation
 - 75 gallon gas hot water heater
 - Copper water piping
 - Automatic fire sprinklers
 - Gas forced-air heating and central air conditioning
- Washer and dryer connections
- Smoke detectors
- Security/fire alarm with call-back capability
- 200 amp electrical service
- Double-hung low-maintenance windows with a sound transmission class rating of 35
- 5/8" oriented strand board roof sheathing
- 2 layers of exterior wall sheathing:
 - 1 layer of 5/8" exterior grade gypsum over 1 layer of 7/16" oriented strand board
 - 2 layers of 1/2" gypsum wallboard on the inside of all exterior walls
- 2 layers of 1/2" gypsum wallboard over resilient channel on the ceiling under the attic
- Acoustically caulked wall penetrations; zero penetrations through the ceiling under the attic; baffled attic and plumbing vents
- Public water and sewer
- Rewired for telephone
- Rewired for cable TV
- Finished basements (site specific)
- Walk-out garden level (site specific)
- Whirlpool tubs
- Washers and dryers
- Central vacuum system
- Intercom and/or sound system



BelleFair
AT RYE BROOK

BELLEFAIR AT RYE BROOK
1150 KING STREET • RYE BROOK, NEW YORK 10573
914-933-BELL (914-933-2355) • FAX: 914-933-1033
www.bellefair.com

Builder reserves the right to make plan and product revisions. Components and materials may be substituted for those of similar quality.